

TWO BED APARTMENT WITH STUNNING VIEWS AND PRIVATE BALCONY



OPEN PLAN LIVING ROOM



VIEW FROM BALCONY

- ◆ Balcony accessed from living room and master bedroom
- ◆ Open plan kitchen living area
- ◆ Two bedrooms, one en-suite
- ◆ Separate laundry room
- ◆ Fourth floor apartment
- ◆ Stunning views
- ◆ Previously owned
- ◆ All white goods included
- ◆ Close to lift



PHOTO FOR ILLUSTRATIVE PURPOSES



PHOTO FOR ILLUSTRATIVE PURPOSES

88 RIVER HOUSE

APARTMENT TYPE F

PLOTS 75-77, 79-86 and 88-90
BEDROOMS 2
SHOWER ROOMS 1 plus WC

Kitchen/dining/living area
7.7m x 3.6m / 25'3" x 11'10"

Bedroom 1
3.6m x 3.6m / 11'10" x 11'10"

Shower room
2.5m x 2.0m / 8'2" x 6'7"

Bedroom 2
3.4m x 3.6m / 11'2" x 11'10"

WC
1.4m x 1.9m / 4'7" x 6'3"

Laundry room
1.8m x 1.9m / 5'11" x 6'3"

Private terrace
1.1m x 7.5m / 3'7" x 24'7"

Total area
78m² / 839sq^{ft}

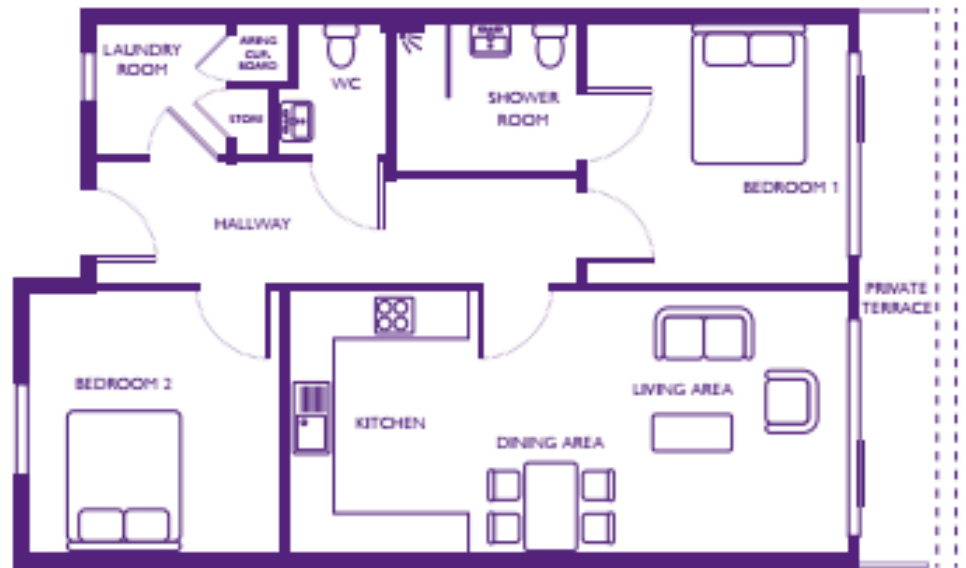

Dimensions shown are maximum. Some plots are handed compared to floorplans. Certain particulars may vary, please check with our sales team. The floor plans depict a typical layout of this apartment type. Floor plans are not to scale. September 2016.

Building converted in August 2017. Please note that this apartment is sold unfurnished and furniture in this floorplan is for reference only. Dimensions shown are maximum. Some plots are handed compared to floorplans. Certain particulars may vary, please check with our sales team. The floorplans depict a typical layout of this apartment type. Floorplans are not to scale. A surrender fee is payable when the property is returned to the Trust (ranging from 1% to 10% of purchase price depending on the lease and length of occupation).

*Neff cooker, Bosch fridge/freezer, dishwasher, washing machine and tumble dryer included.

SALES ENQUIRIES

If you are interested in viewing any of our apartments or would like some further information please call our Sales Team on

0117 949 4004



St Monica Trust

email sales.team@stmonicatrust.org.uk

